

CREEK COUNTY

PAWNEE COUNTY

Note Casing #s in BLUE - Bigger above sea level subsea casing #s to surrounding data points **must** be honored vice versa  
 Smaller above sea level subsea casing #s to surrounding data points **do not** have to be honored.  
 All casing point #s have 50 feet added to them.

OCC BTW MAP  
 Creek County, OK  
 Oklahoma Corporation Commission  
 Base of the Treatable Water (datum)  
 circa November, 1999

by:  
 Dennis Niskern  
 Oklahoma Geological Survey  
 Open-File Report 15-2004  
This map, prepared by the staff of the Oklahoma Corporation Commission, is being distributed by the Oklahoma Geological Survey as a service to the public.  
 For official, updated information please contact:

Twp. & Ranges, & Sections	Minimum Surface Casing	Order No.	Remarks
T14N-R7E All 1, NE 12	None per order	67796, 72566	Depew Gas Storage in Dutcher 3250'
T14N-R8E All 5, all 6, N/2 7	None per order	67796, 72566	Depew Gas Storage in Dutcher 3250'
T15N-R7E S/2 NW, NW NW, N/2 SW 4, all 5, all 6, NE 7, NW 8 All of Township	Use attached Map surface casing is calculated by subtracting number from map from location's elevation D.V. Permitted	85634 82644	City of Stroud City of Bristow
T15N-R7E S/2 NE, NW, E/2 SW, SE 13, NE, S/2 24, SE SE, S/2 NE SE 23, all 25, E/2 26, E/2 35, all 36	None per order	67796, 72566	Depew Gas Storage in Dutcher 3250'
T15N-R8E S/2 18, all 19, W/2 29, all 30, all 31, all 32	None per order	67796, 72566	Depew Gas Storage in Dutcher 3250'
T15N-R8E All of township	Use attached Map surface casing is calculated by subtracting number from map from location's elevation D.V. Permitted	82644	City of Bristow
T15N-R9E All of township except Sections 1, 12, 13, 24, 25, 36	As above	82644	City of Bristow
T16N-R7E All of township except Section 4	As above	82644	City of Bristow
T16N-R7E S/2 29, all 30, all 31, all 32, W/2 SW 33	As above	85634	City of Stroud
T16N-R8E All of township	As above	82644	City of Bristow
T16N-R9E All of township except Sections 1, 12, 13, 24, 25, 36	As above	82644	City of Bristow
T17N-R6E (part in Payne) All 1, 12, 13	Surface casing is calculated by subtracting 125' from the elevation D.V. Permitted	70256	City of Drumright
T17N-R7E All of township	As above	70256	City of Drumright
T17N-R8E All of township	As above	70256	City of Drumright
T17N-R9E All of township except Sections 1, 12, 13, 24, 25, 36	Use attached Map surface casing is calculated by subtracting number from map from location's elevation D.V. Permitted	82644	City of Bristow
T18N-R6E (part in Payne) All 24, 25, 36	Surface casing is calculated by subtracting 125' from the elevation D.V. Permitted	70256	City of Drumright
T18N-R7E All of township	As above	70256	City of Drumright
T18N-R8E All of township	As above	70256	City of Drumright

George A. Dunaway  
 Geological Engineer  
 Cushing, OK  
 February, 1970

FOR EXAMPLE: DETERMINE THE DEPTH TO SET A PROTECTIVE SHIELD AT A POINT IN THE SW/4 NW/4 SE/4, OF SECTION 24, TOWNSHIP 16 NORTH, RANGE 8 EAST. HERE THE SURFACE ELEVATION IS 902 FEET ABOVE MEAN SEA LEVEL. THE ELEVATION FOR 50 FEET BELOW THE BASE OF FRESH WATER BEARING SANDSTONES FROM THIS MAP IS 410 FEET ABOVE MEAN SEA LEVEL. ELEVATIONS CAN BE EXTRAPOLATED BETWEEN CONTOUR LINES. THE DIFFERENCE BETWEEN SURFACE ELEVATION OF 902 FEET AND THE 410 FOOT ELEVATION IS 492 FEET. THEREFORE, THE REQUIRED PROTECTIVE SHIELD IS 492 FEET.

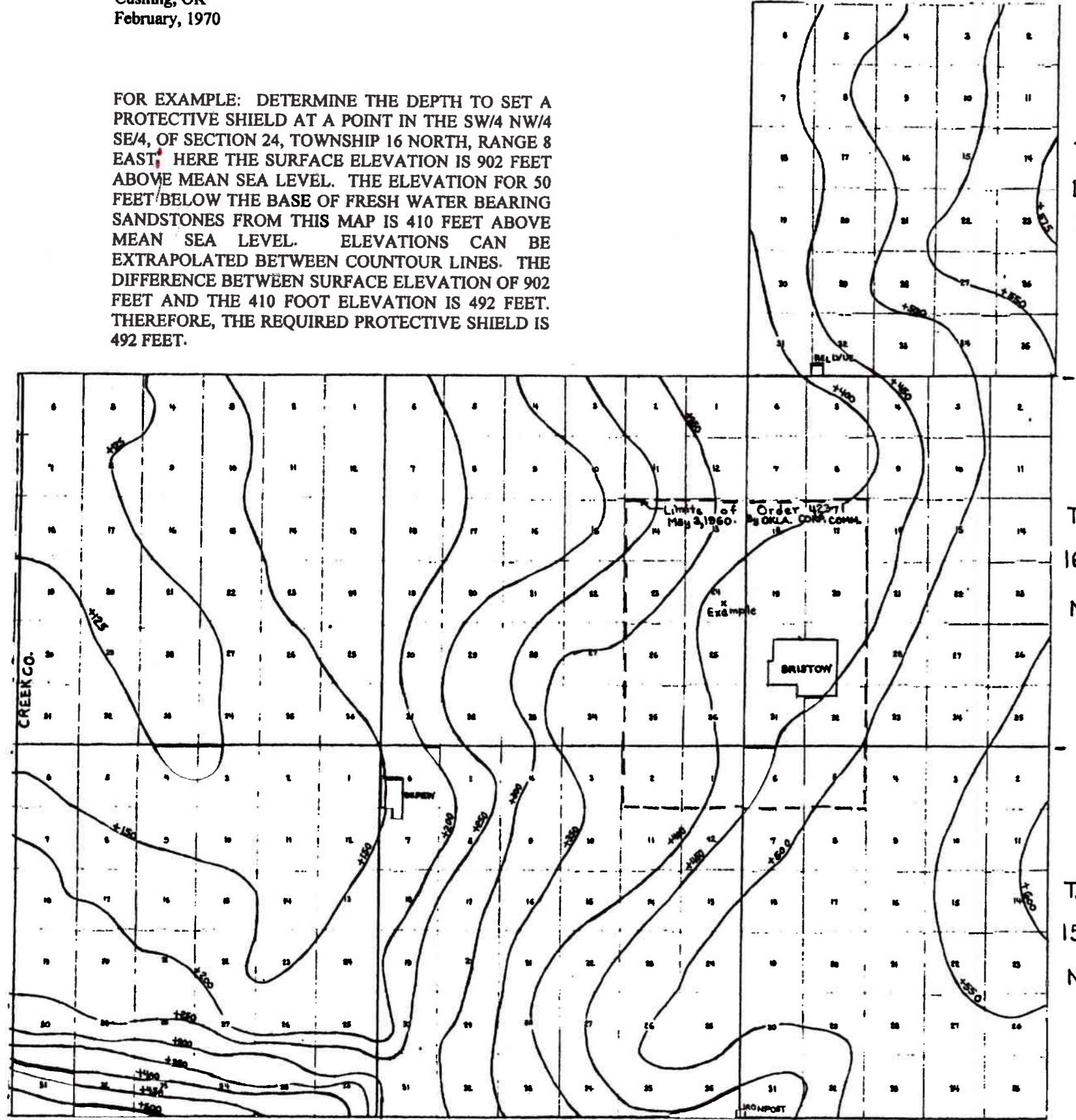

R.7.E. R.8.E. R.9.E.  
 THIS MAP SHOWS THE ELEVATION ABOVE MEAN SEA LEVEL OR A SURFACE WHICH IS 50 FEET BELOW THE DEPTH SUBSURFACE FRESH GROUND WATER BEARING SANDSTONES.  
 PROTECTION OF THE SOURCE OF CITY OF BRISTOW, OKLAHOMA GROUND WATER SUPPLY, BY SETTING OF SURFACE PIPE OR EQUIVALENT SHIELD.

PAYNE COUNTY

LINCOLN COUNTY

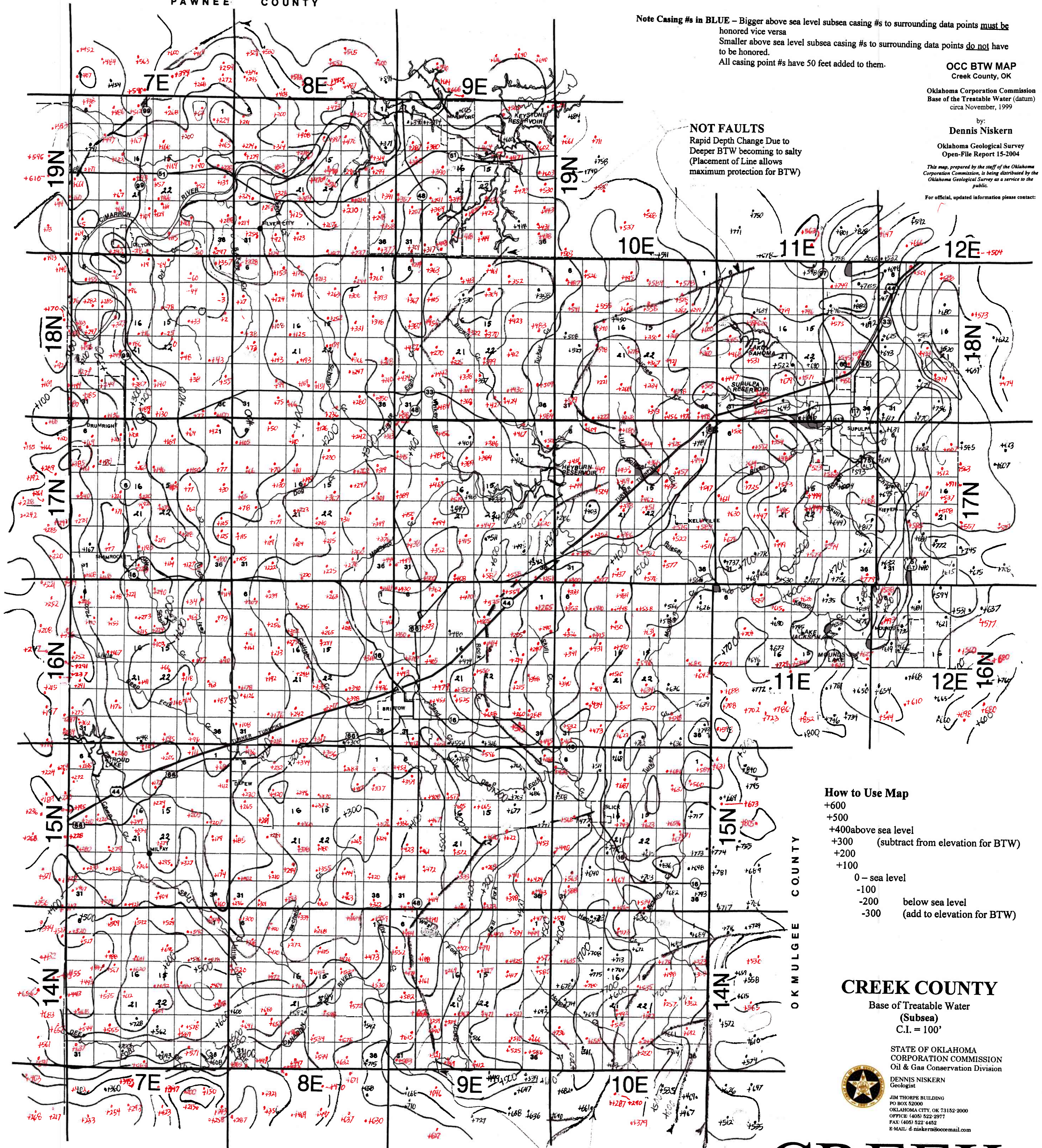

NOT FAULTS  
 Rapid Depth Change Due to Deeper BTW becoming to salty  
 (Placement of Line allows maximum protection for BTW)

**How to Use Map**  
 +600  
 +500  
 +400 above sea level  
 +300 (subtract from elevation for BTW)  
 +200  
 +100  
 0 - sea level  
 -100  
 -200 below sea level  
 -300 (add to elevation for BTW)

**CREEK COUNTY**  
 Base of Treatable Water  
 (Subsea)  
 C.I. = 100'

STATE OF OKLAHOMA  
 CORPORATION COMMISSION  
 Oil & Gas Conservation Division  
 DENNIS NISKERN  
 Geologist  
 JIM THORPE BUILDING  
 PO BOX 52000  
 OKLAHOMA CITY, OK 73152-2000  
 OFFICE: (405) 522-2977  
 FAX: (405) 522-4452  
 E-MAIL: d.niskern@occcmail.com

**CREEK**

NOT FAULTS  
 Rapid Depth Change Due to Deeper BTW becoming to salty  
 (Placement of Line allows maximum protection for BTW)

OKLAHOMA WATER

TULSA COUNTY

OKFUSKEE COUNTY

