

Prairie-Slick No.1 Sudick
8-10-2 W Elev 1224

Sinclair No.1 School Land-67
36-11-3 W Elev 1323

IT10-Foster No.1 Emerson
30-11-2 W Elev 1302

Shell No.1 Petty
30-11-2 W Elev 1301

Prairie-Slick No.1 Hiddleston
19-11-2 W Elev 1301

IT10-Foster No.2 GButton
30-11-2 W Elev 1257

Coline No.1 Warren
18-11-2 W Elev 1246

Coline No.2 Warren
18-11-2 W Elev 1240

IT10-Foster No.1 Zeherle
13-11-3 W Elev 1259



IT10-Foster No.2 Themer
12-11-3 W Elev 1191

Magnolia No.1 Noble
30-12-2 W Elev 1163

Cromwell-Franklin No.1 Thompson
15-12-3 W Elev 1172

-1800 FT. BELOW SEA LEVEL DATUM

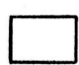
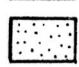
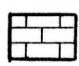
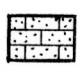
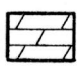
SYMBOLS

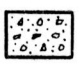
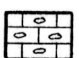
-  Shale
-  Sandstone
-  Limestone
-  Sandy Lime
-  Dolomite
-  Sandy Dolomite
-  Detrital Material
-  Chert

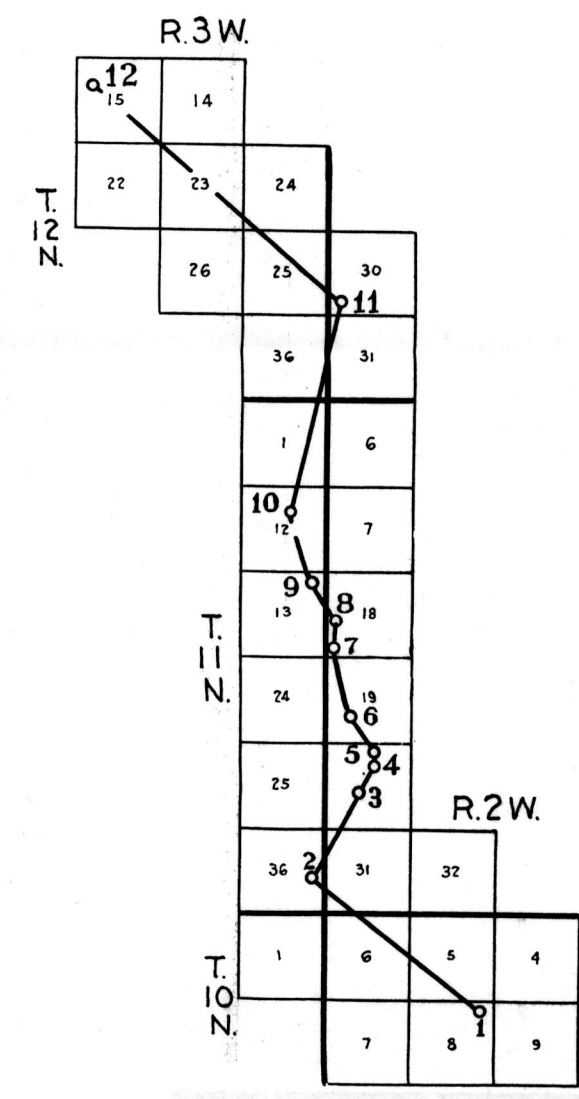

INDEX MAP SHOWING AREA OF CROSS-SECTION

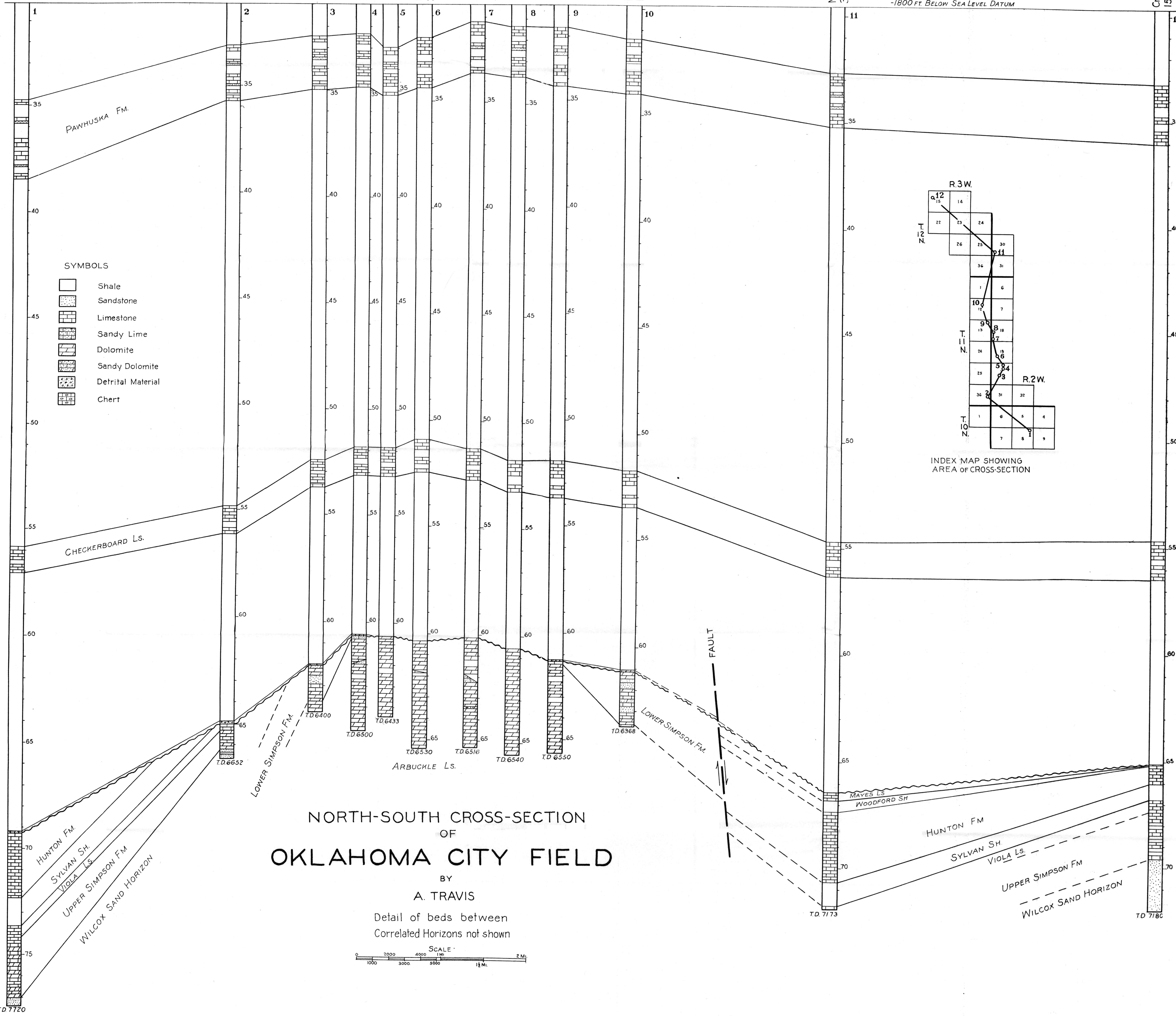

NORTH-SOUTH CROSS-SECTION
OF
OKLAHOMA CITY FIELD

BY
A. TRAVIS

Detail of beds between
Correlated Horizons not shown

